

# KEEPS YOU MOVING

## FCR Brake Motors

The Browning FCR brake motor provides a braking solution that is ideal for many material handling applications. The FCR is a rugged, high performance, DC (direct current) brake. The FCR brake is also shorter in overall length than many AC brakes.

### PRODUCT SCOPE

- 1/3 - 5 HP, 4-pole
- 230/460 VAC/60 Hz, 575 VAC/60 Hz, or 380 VAC/50 Hz
- Indoor/Outdoor TEFC Motor with IP55 Brake
- Gearmotor with Worm or Concentric Gearing (Series 2000, 3000, 7000, or IRA)
- NEMA C-Face Footless Motor
- Available with True Inverter Duty Motor Design
- Available with Built-in IntelliGear Plus VFD
- Brake sets on Power Removal

### TYPICAL APPLICATIONS

- Turnstiles
- General Conveyors
- Diverters & Sorters
- Palletizers
- Incline Conveyors
- Hoisting
- Special Machinery



**Browning**<sup>®</sup>

  
**EMERSON**<sup>™</sup>  
Industrial Automation

EMERSON. CONSIDER IT SOLVED.®

# ...STOPS WHEN YOU NEED TO

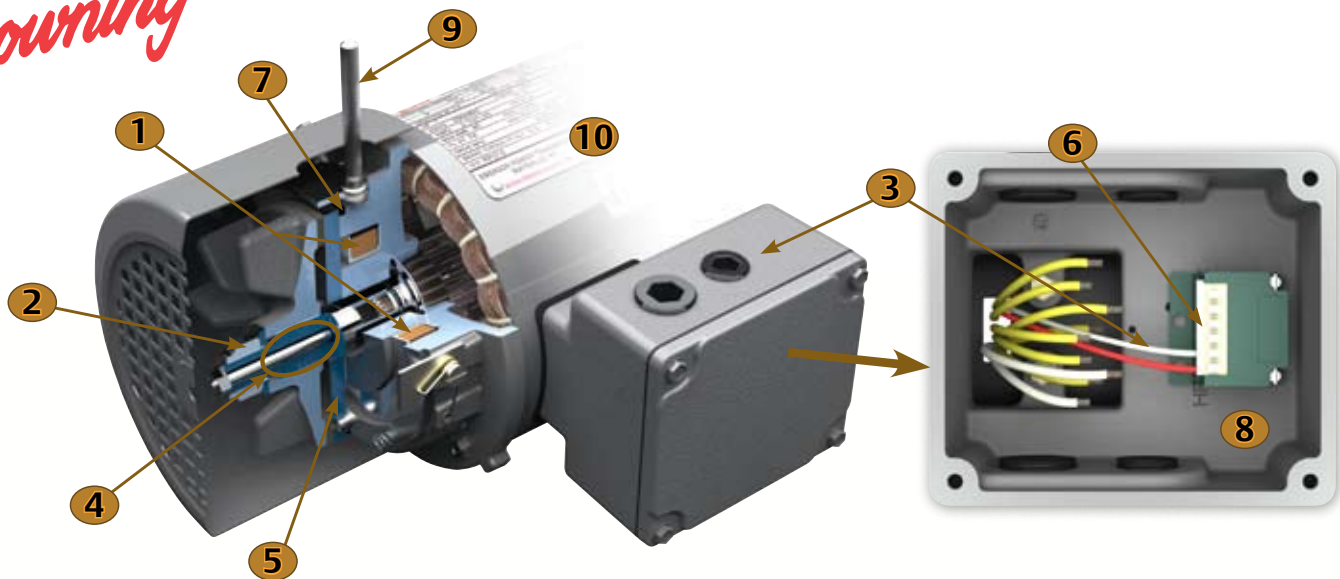

## FCR Construction Features/Benefits

- 1 Encapsulated Brake Coil**  
Seals out moisture and contaminants.
- 2 Easy Access for Maintenance**  
"Adjustment Nut" located just under motor fan cover for quick, simple air gap adjustment.
- 3 Ease of Installation**  
Brake leads pre-wired to rectifier (provided) in main oversized conduit box. All wiring in one location with four threaded hubs for convenience.
- 4 Brake Integral to Motor Shaft**  
Eliminates adapters and provides highest integrity of connection from the brake to the motor.
- 5 Simplest Set or Release of Brake**  
Only one part (armature plate) moves. Improves performance in high cycling applications. No wear-prone linkages found in other brakes.
- 6 Rectifier Accommodates Fast Setting**  
Removable jumper can be replaced by user supplied remote DC contact for faster setting of brake. Required in certain applications including hoisting.
- 7 Quiet Operation**  
Equipped with "silence ring" to deliver quiet brake actuation and release.
- 8 Booster Option for Fast Release**  
Can replace standard rectifier for fastest brake release and faster setting.
- 9 Manual Release is Standard**  
Supplied with removable handle in one of four possible positions.
- 10 CSA, UL and CE Marking**  
Multiple approvals for use in North America and Europe.

For Rapid Availability For Rapid Availability For Rapid Availability

GEARMOTOR DESIGNS - SPECIFY

	Motor Power Supply	Motor Type
Sine Wave	230/460 VAC - 60 Hz 380 VAC - 50 Hz	MTB
	575 VAC - 60 Hz	MVB
VFD	230/460 VAC - 60 Hz	MIB
	575 VAC - 60 Hz	MDB

Gearmotor Example:  
CbN 3363-S-B3-71-MVB-145T-1.5 hp

C-FACE FOOTLESS MOTOR MODELS - ORDER

Motor Power Supply	Motor HP									
	1/3	1/2	3/4	1	1 1/2	2	3	5		
	56C	56C	56C	B56C	143TC	145TC	145TC	182TC	184TC	
Sine Wave	230/460 VAC - 60 Hz 380 VAC - 50 Hz	RC0100	RD0100	RE0100	RF0150	RF0100	RG0100	RH0100	RK0100	RM0100
	575 VAC - 60 Hz	RC0600	RD0600	RE0600	RF0650	RF0600	RG0600	RH0600	RK0600	RM0600
VFD	230/460 VAC - 60 Hz	RC0151	RD0151	RE0151	RF0159	RF0151	RG0151	RH0151	RK0151	RM0151
	575 VAC - 60 Hz	RC0651	RD0651	RE0651	RF0659	RF0651	RG0651	RH0651	RK0651	RM0651

For Additional Assistance Please Contact Application Engineering at 1-800-626-2095

APPLICATION CONSIDERATIONS

The proper selection and application of power transmission products and components, including the related area of product safety, is the responsibility of the customer. Operating and performance requirements and potential associated issues will vary appreciably depending upon the use and application of such products and components. The scope of the technical and application information included in this publication is necessarily limited. Unusual operating environments and conditions, lubrication requirements, loading supports, and other factors can materially affect the application and operating results of the products and components and the customer should carefully review its requirements. Any technical advice or review furnished by Emerson Power Transmission Corporation and its divisions with respect to the use of products and components is given in good faith and without charge, and Emerson assumes no obligation or liability for the advice given, or results obtained, all such advice and review being given and accepted at customer's risk.

For a copy of our Standard Terms and Conditions of Sale, Disclaimers of Warranty, Limitation of Liability and Remedy, please contact Emerson Power Transmission Customer Service at 1-800-626-2120. These terms and conditions of sale, disclaimers and limitations of liability apply to any person who may buy, acquire or use an Emerson Power Transmission Corporation product referred to herein, including any person who buys from a licensed distributor of these branded products.